



KONICA MINOLTA

# bizhub 654e

Black & white A3 multifunctional

Up to 65 pages per minute

## Functionality



Copying

- Black & white



Printing

- Black & white
- PCL/PS
- Local/Network
- USB



Scanning

- Colour
- Black & white
- Scan-to-eMail
- Scan-to-Me
- Scan-to-SMB
- Scan-to-Home
- Scan-to-FTP
- Scan-to-Box
- Scan-to-USB
- Scan-to-WebDAV
- Scan-to-DPWS
- TWAIN Network



Faxing

- Super G3 Fax
- PC-Fax
- i-Fax
- IP-Fax



Box

- Reprint
- Distribution
- Sharing
- Box-to-Box
- Box-to-USB



Giving Shape to Ideas

## Technology

Emperon™ – print controller	Easily compatible with different users and IT environments through Konica Minolta's unified print technology	✓
Simitri® HD – polymerised toner	Delivers high print quality and yet ensures reduced print spending as well as lower environmental impact	✓
OpenAPI – solution platform	Server-based applications provide efficient workflows for the entire MFP fleet	✓
i-Option – special feature	Offers extended scope and advanced MFP functionality in line with individual requirements	✓
CSRC – remote service	Keeps productivity up with online monitoring of devices and consumables through the Konica Minolta service	✓
IWS – panel customisation	Improved user-device interaction and enhanced productivity through full MFP panel customisation	✓

## Option diagram

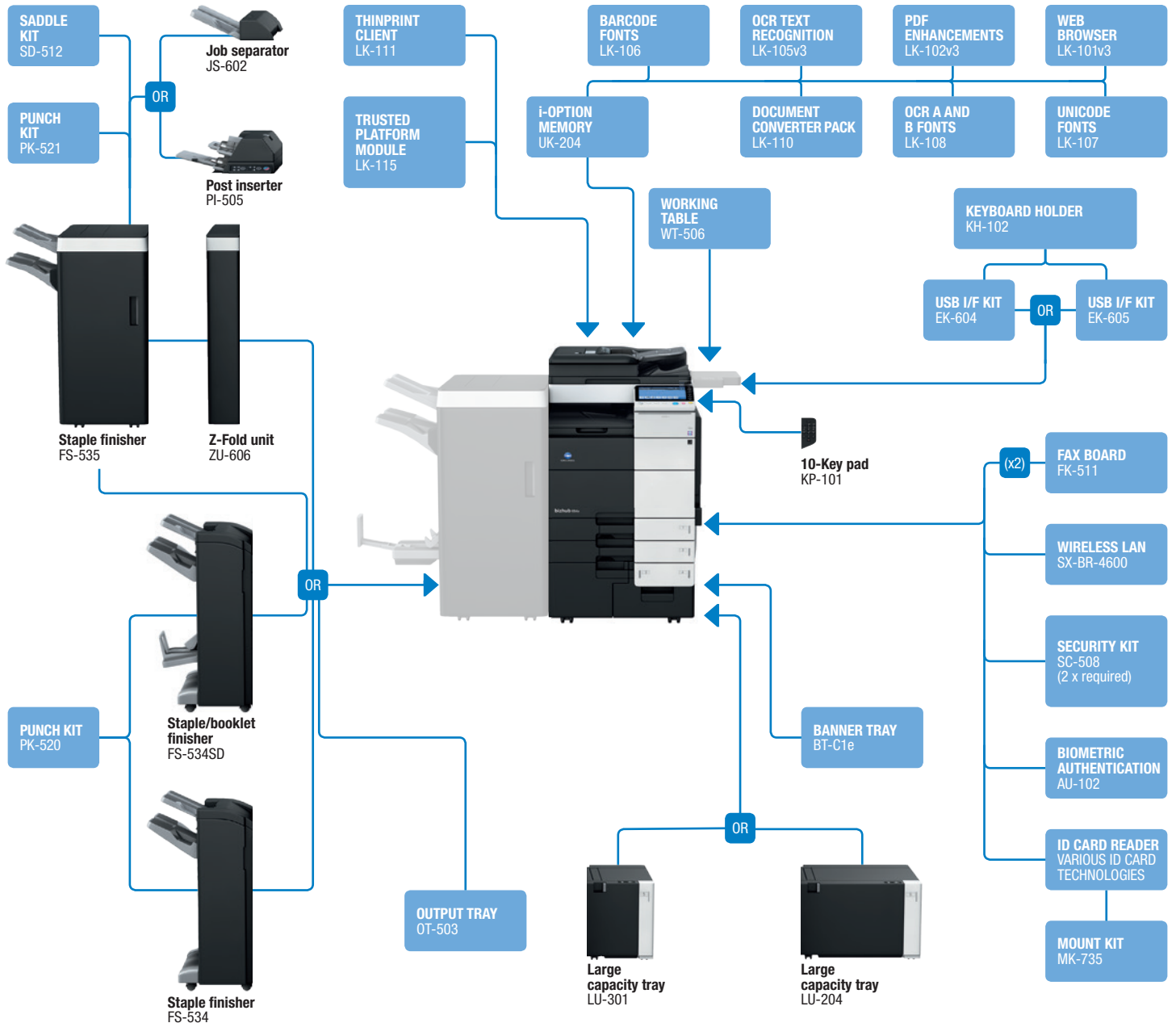

## Finishing functionalities

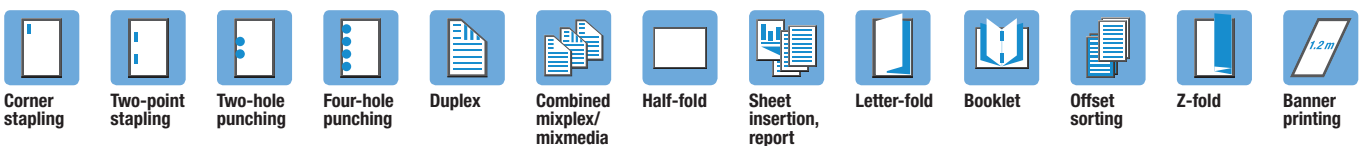

## Descriptions

<b>bizhub 654e</b>	Communication centre with 65 ppm b/w. Standard Emperon™ print controller with PCL 6, PCL 5, PostScript 3, PDF 1.7, XPS and OOXML support. Paper capacity of 500 + 500 + 1000 + 1500 sheets and 150-sheet manual bypass. Media from A6 to SRA3, 1.2 m banner and 52–300 gsm. 2 GB memory, 250 GB hard disk and Gigabit Ethernet standard.
<b>LU-204 Large capacity tray</b>	A4–SRA3, 2,500 sheets, 52–256 gsm
<b>LU-301 Large capacity tray</b>	A4, 3,000 sheets, 52–256 gsm
<b>FS-534 Staple finisher</b>	50-sheet stapling, 3,200 sheets max. output
<b>FS-534SD Booklet finisher</b>	50-sheets staple finisher, 20-sheets booklet finisher, 2,200 sheets max. output
<b>PK-520 Punch kit for FS-534/SD</b>	2/4 hole punching, autoswitching
<b>FS-535 Staple finisher</b>	100 sheets stapling, 3,200 sheets max. output
<b>PK-521 Punch kit for FS-535</b>	2/4 hole punching, autoswitching
<b>SD-512 Saddle kit for FS-535</b>	Booklet finishing, half-fold, letter-fold
<b>PI-505 Post inserter for FS-535</b>	Cover insertion, post finishing
<b>JS-602 Job separator for FS-535</b>	Separation of fax output, etc.
<b>ZU-606 Z-fold unit for FS-535</b>	Z-fold for A3 prints, 2/4 hole punching
<b>OT-503 Output tray</b>	Output tray used instead of finisher
<b>KP-101 10-Key pad</b>	For use instead of touchscreen
<b>WT-506 Working table</b>	Authentication device placement

<b>FK-511 Fax board</b>	Super G3 fax, digital fax functionality
<b>KH-102 Keyboard holder</b>	To place USB keyboard
<b>EK-604 USB I/F kit</b>	USB keyboard connection
<b>EK-605 USB I/F kit</b>	USB keyboard connection, Bluetooth
<b>ID card reader</b>	Various ID card technologies
<b>MK-735 Mount kit</b>	Installation kit for ID card reader
<b>AU-102 Biometric authentication</b>	Finger vein scanner
<b>SC-508 Security kit</b>	Copy guard function
<b>BT-C1e Banner tray</b>	Multi-page banner feeding
<b>LK-101v3 Web browser</b>	Web browser and IWS
<b>LK-102v3 PDF enhancements</b>	PDF/A, PDF encryption, digital signature
<b>LK-105v3 OCR text recognition</b>	Searchable PDF and PPTX
<b>LK-106 Barcode fonts</b>	Supports native barcode printing
<b>LK-107 Unicode fonts</b>	Supports native Unicode printing
<b>LK-108 OCR A and B fonts</b>	Supports native OCR A and B font printing
<b>LK-110 Document converter pack</b>	Generates various file formats incl. DOCX, XLSX and PDF/A
<b>LK-111 ThinPrint® Client</b>	Print data compression for reduced network impact
<b>LK-115 TPM activation</b>	Trusted Platform Module for protection of data encryption and decryption
<b>UK-204 i-Option memory</b>	Memory extension for i-Options
<b>SX-BR-4600 Wireless LAN</b>	Wireless LAN to network connector

## Technical specifications

### SYSTEM SPECIFICATIONS

<b>System memory</b>	2,048 MB
<b>System hard disk</b>	250 GB
<b>Interface</b>	10-Base-T/100-Base-T/1,000-Base-T Ethernet; USB 2.0
<b>Network protocols</b>	TCP/IP (IPv4 / IPv6); IPX/SPX; NetBEUI; AppleTalk (EtherTalk); SMB; LPD; IPP; SNMP; HTTP
<b>Frame types</b>	Ethernet 802.2; Ethernet 802.3; Ethernet II; Ethernet SNAP
<b>Automatic document feeder</b>	Up to 150 originals; A6–A3; 35–210 gsm Dualscan ADF
<b>Printable paper size</b>	A6–SRA3, customised paper sizes; banner paper max. 1,200 x 297 mm
<b>Printable paper weight</b>	52–300 gsm
<b>Paper input capacity</b>	Standard: 3,650 sheets Max.: 6,650 sheets
<b>Tray 1</b>	500 sheets, A5–SRA3, 52–256 gsm
<b>Tray 2</b>	500 sheets, A5–SRA3, 52–256 gsm
<b>Tray 3</b>	1,500 sheets, A4, 52–256 gsm
<b>Tray 4</b>	1,000 sheets, A4, 52–256 gsm
<b>Large capacity tray LU-301 (optional)</b>	3,000 sheets, A4, 52–256 gsm
<b>Large capacity tray LU-204 (optional)</b>	2,500 sheets, A4–SRA3, 52–256 gsm
<b>Manual bypass</b>	150 sheets, A6–SRA3, custom sizes, banner, 52–300 gsm
<b>Automatic duplexing</b>	A5–SRA3; 52–256 gsm
<b>Finishing modes (optional)</b>	Offset; group; sort; staple; punch; post insertion; z-fold; centre-fold; letter fold; booklet
<b>Output capacity (with finisher)</b>	Max.: 3,300 sheets
<b>Output capacity (without finisher)</b>	Max.: 250 sheets
<b>Stapling</b>	Max.: 100 sheets or 94 sheets + 2 cover sheets (up to 209 gsm)
<b>Stapling output capacity</b>	Max.: 1,000 sheets
<b>Letter fold</b>	Up to 3 sheets
<b>Letter fold capacity</b>	Max.: 30 sheets (tray); unlimited
<b>Booklet</b>	Max.: 20 sheets or 19 sheets + 1 cover sheet (up to 209 gsm)
<b>Booklet output capacity</b>	Max.: 100 sheets (tray); unlimited
<b>Copy/print volume (monthly)</b>	Rec.: 80,000 pages; Max. <sup>1</sup> : 187,000 pages
<b>Toner lifetime</b>	48,960 pages
<b>Imaging unit lifetime</b>	300,000 pages/1,200,000 pages (Drum/Developer)
<b>Power consumption</b>	220–240 V / 50/60 Hz Less than 2.1 kW (system)
<b>System dimensions (W x D x H)</b>	650 x 799 x 1,155 mm
<b>System weight</b>	Approx. 201 kg

### COPIER SPECIFICATIONS

<b>Copying process</b>	Electrostatic laser copy, tandem, indirect
<b>Toner system</b>	Simitri® HD polymerised toner
<b>Copy/print speed A4</b>	Up to 65 ppm
<b>Copy/print speed A3</b>	Up to 33 ppm
<b>Autoduplex speed A4</b>	Up to 65 ppm
<b>1st copy out time</b>	3.7 sec.
<b>Warm-up time</b>	Approx. 22 sec. <sup>2</sup>
<b>Copy resolution</b>	600 x 600 dpi
<b>Gradation</b>	256 gradations
<b>Multicopy</b>	1–9,999
<b>Original format</b>	A5–A3
<b>Magnification</b>	25–400% in 0.1% steps; auto-zooming
<b>Copy functions</b>	Chapter; cover and page insertion; proof copy (print and screen); adjustment test print; digital art functions; job setting memory; poster mode; image repeat; overlay (optional); stamping; copy protection

<sup>1</sup> If the maximum volume is reached within a period of one year, then a maintenance cycle must be performed

<sup>2</sup> Warm-up time may vary depending on the operating environment and usage

**PRINTER SPECIFICATIONS**

<b>Print resolution</b>	1,800 x 600 dpi; 1,200 x 1,200 dpi
<b>Page description language</b>	PCL6 (XL 3.0); PCL 5; PostScript 3 (CPSI 3016); XPS
<b>Operating systems</b>	Windows VISTA (32/64) Windows 7 (32/64) Windows 8 (32/64) Windows Server 2000 Windows Server 2003 (32/64) Windows Server 2008 (32/64) Windows Server 2008 R2 Windows Server 2012 Windows Server 2012 R2 Macintosh OS X 10.x Unix, Linux, Citrix
<b>Printer fonts</b>	80 PCL Latin; 137 PostScript 3 Emulation Latin
<b>Print functions</b>	Direct print of PCL, PS, TIFF, XPS, PDF (v1.7); encrypted PDF files and OOXML (DOCX, XLSX, PPTX); mixmedia and mixplex; "Easy Set" job programming; overlay; watermark; copy protection; carbon copy print
<b>Mobile Printing</b>	AirPrint (iOS), Mopria (Android), Google Cloud Print (optional), Konica Minolta Print Service (Android), PageScope Mobile (iOS & Android)

**SCANNER SPECIFICATIONS**

<b>Scan speed (mono/colour)</b>	Up to 180 ipm
<b>Scan resolution</b>	Max.: 600 x 600 dpi
<b>Scan modes</b>	Scan-to-eMail (Scan-to-Me) Scan-to-SMB (Scan-to-Home) Scan-to-FTP Scan-to-Box Scan-to-USB Scan-to-WebDAV Scan-to-DPWS Network TWAIN scan
<b>File formats</b>	JPEG; TIFF; PDF; PDF/A 1a and 1b (optional); Compact PDF; encrypted PDF; searchable PDF (optional); XPS; compact XPS; PPTX and searchable PPTX (optional); searchable DOCX/ XLSX (optional)
<b>Scan destinations</b>	2,100 (single + group); LDAP support
<b>Scan functions</b>	Annotation (text/time/date) for PDF; up to 400 job programs; realtime scan preview

**FAX SPECIFICATIONS**

<b>Fax standard</b>	Super G3 (optional)
<b>Fax transmission</b>	Analogue i-Fax Colour i-Fax (RFC3949-C) IP-Fax
<b>Fax resolution</b>	Max.: 600 x 600 dpi (ultra-fine)
<b>Fax compression</b>	MH; MR; MMR; JBIG
<b>Fax modem</b>	Up to 33.6 Kbps
<b>Fax destinations</b>	2,100 (single + group)
<b>Fax functions</b>	Polling; time shift; PC-Fax; receipt to confidential box; Receipt to e-mail/FTP/SMB; up to 400 job programs

**USER BOX SPECIFICATIONS**

<b>Max. storable documents</b>	Up to 3,000 documents or 10,000 pages
<b>Type of user boxes</b>	Public Personal (with password or authentication) Group (with authentication)
<b>Type of system boxes</b>	Secure print Encrypted PDF print Fax receipt Fax polling
<b>User box functionality</b>	Reprint; combination Download Sending (e-mail/FTP/SMB and fax) Copy box to box

**SYSTEM FEATURES**

<b>Security</b>	ISO15408/IEEE 2600.1 (in evaluation); IP filtering and port blocking; SSL2; SSL3 and TLS1.0 network communication; IPsec support; IEEE 802.1x support; user authentication; Authentication log; secure print; Hard disk overwrite (8 standard types); Hard disk data encryption (AES 256); Memory data auto deletion; Confidential fax receipt; Print user data encryption; copy protection (Copy Guard, Password Copy) optional
<b>Accounting</b>	Up to 1,000 user accounts; Active Directory support (user name + password + e-mail + smb folder) User function access definition Biometric authentication (finger vein scanner) optional ID card authentication (ID card reader) optional"
<b>Software</b>	PageScope Net Care Device Manager PageScope Data Administrator PageScope Box Operator PageScope Direct Print Print Status Notifier Driver Packaging Utility Log Management Utility

- All specifications refer to A4-size paper of 80 gsm quality.
- The support and availability of the listed specifications and functionalities varies depending on operating systems, applications and network protocols as well as network and system configurations.
- The stated life expectancy of each consumable is based on specific operating conditions such as page coverage for a particular page size (5% coverage of A4). The actual life of each consumable will vary depending on use and other printing variables including page coverage, page size, media type, continuous or intermittent printing, ambient temperature and humidity.
- Some of the product illustrations contain optional accessories.
- Specifications and accessories are based on the information available at the time of printing and are subject to change without notice.
- Konica Minolta does not warrant that any specifications mentioned will be error-free.
- All brand and product names may be registered trademarks or trademarks of their respective holders and are hereby acknowledged.



Visit our product page